

An architectural rendering of a modern building complex. The scene features several multi-story buildings with curved facades and large glass windows. A central courtyard area is visible, containing a paved walkway, a small garden with purple flowers, and a few people walking. The sky is a clear, bright blue. The overall aesthetic is clean and contemporary.

**FIDAN**  
PROPERTY

FI 683



# General Information

Location **Istanbul – Ataşehir**

Apartment type **Offices - Shops**

Price **Starting from 440.000 \$**

Area **74 - 443 m2**

Distance to Taksim **25 Minutes**

Distance to Sabiha Airport **30 Minutes**

Distance to Metro Station **5 Minutes**

Delivery date **2024**









# Price list & Payment method

## Offices

74 - 256 m2

## Shops

85 - 443 m2

Starting From 440.000 \$

## Cash & Installment Option





# ZEMİN KAT

3649.60 m<sup>2</sup>

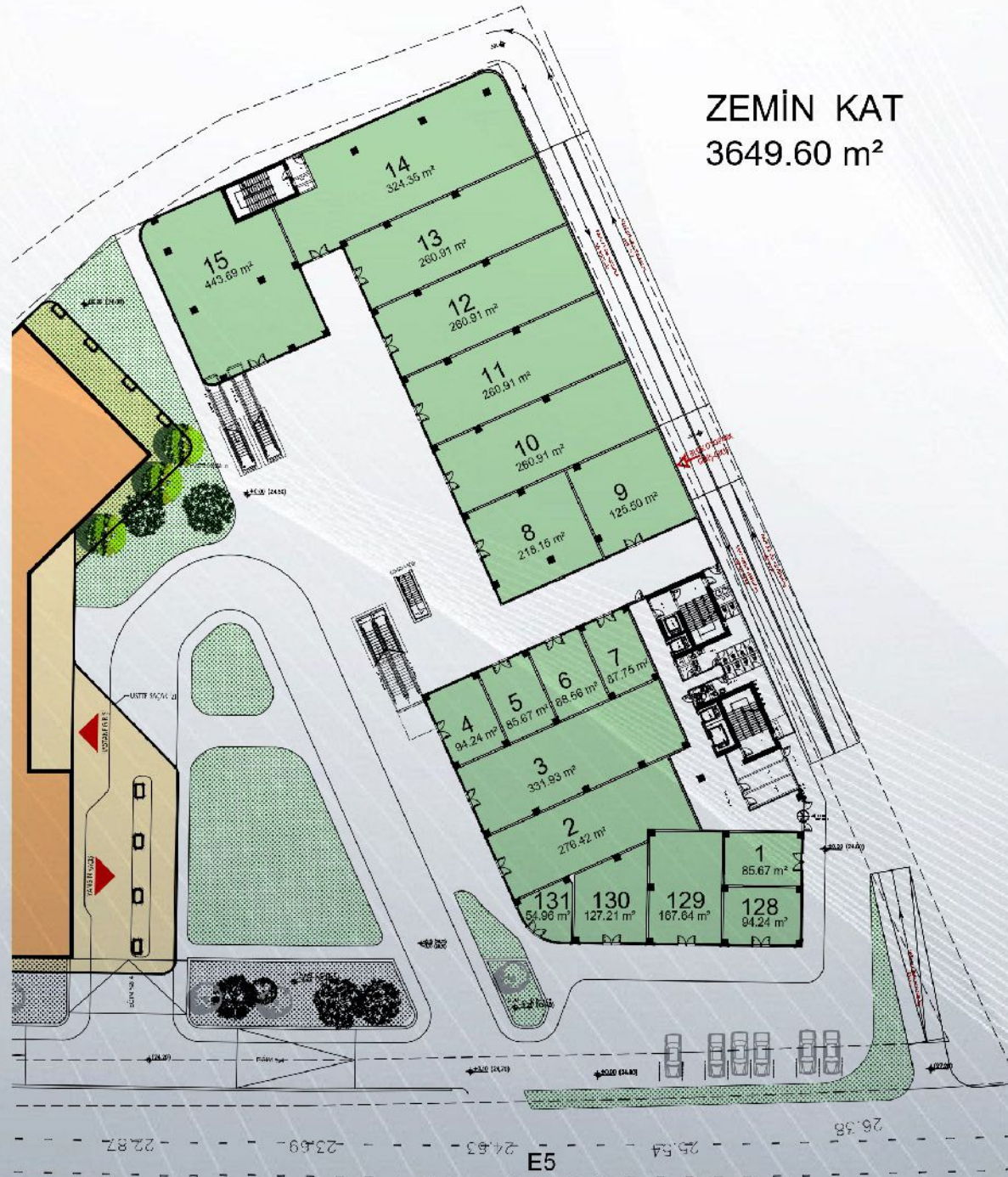



3. KAT OFİS  
1194.23 m<sup>2</sup>





# FIDAN PROPERTY





# Social Facilities

Cafes

Parking

Security System









Sabiha Airport : 31 km

Marmara Sea : 5 km

Metro Station : 1.5 km

Taksim : 15 km

Eminönü : 19 km

Nearest Mall : 2 km

Nearest Hospital : 650 m

## Project Location











**FIDAN**  
PROPERTY

 +90 552 866 55 57

 [info@fidanproperty.com](mailto:info@fidanproperty.com)

 [www.fidanproperty.com](http://www.fidanproperty.com)