



The image is a detailed architectural rendering of a modern residential complex at dusk. The central focus is a multi-story apartment building with a prominent central tower. The building's facade is composed of light-colored panels and large glass windows, many of which are illuminated from within, showing interior furniture and balconies with plants. The balconies have dark metal railings. In the foreground, there is a ground-level area with a swimming pool, a playground with wooden structures, and a row of shops with large glass windows. The sky is dark with a crescent moon in the upper right corner. The overall atmosphere is modern and sophisticated.

FIDAN
PROPERTY

D BLOK
FI 678

General Information

Location **Istanbul – Başakşehir**

Apartment type **3+1 - 4+1**

Price **Starting from 581.363 \$**

Area **170 – 211 m2**

Distance to Taksim **35 Minutes**

Distance to Istanbul Airport **20 Minutes**

Distance to metro station **1 Minute**

Delivery date **12 / 2024**





Price list & Payment method

3+1

170 m²

581.363 - 760.853 \$

4+1

211 m²

724.288 - 943.259 \$

35 % Down Payment 36 Months Installment





FIDAN
PROPERTY





3+1 DAİRE

NET ALAN:	111,00 m ²
BALKON DAHİL NET ALAN:	117,50 m ²
BRÜT ALAN:	170,40 m ²
1 - ANTRE + HOL :	12,90 m ²
2- MUTFAK :	14,75 m ²
3- SALON :	33,45 m ²
4- E. YATAK ODASI :	16,00 m ²
5- GİYİNME ODASI :	3,50 m ²
6- E. BANYO :	3,60 m ²
7- YATAK ODASI :	10,50 m ²
8- YATAK ODASI :	10,60 m ²
9- ÇAMAŞIR ODASI :	1,00 m ²
10- BANYO :	4,70 m ²
11- BALKON :	6,50 m ²

Blok no / Daire no:

A Blok :
2-3-4-5-6-7-8-9 No'lu Daire

B Blok :
3-4-5-6-7-8-9-10 No'lu Daire

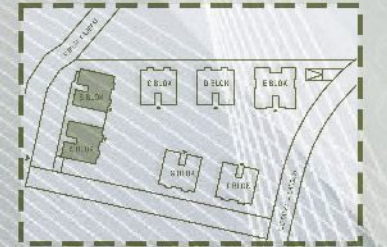

ANAHTAR VAZİYET PLANI



4+1 DAİRE

NET ALAN:	136,40 m ²
TERAS DAHİL NET ALAN:	162,60 m ²
BRÜT ALAN:	235,75 m ²
1 - ANTRE + HOL :	16,90 m ²
2- MUTFAK :	14,70 m ²
3- SALON :	40,00 m ²
4- OTURMA ODASI :	13,35 m ²
5- E. YATAK ODASI :	14,80 m ²
6- GİYİNME ODASI :	5,00 m ²
7- E. BANYO :	4,00 m ²
8- YATAK ODASI :	10,40 m ²
9- YATAK ODASI :	9,90 m ²
10- ÇAMAŞIR ODASI :	1,80 m ²
11- BANYO :	5,55 m ²
12-TERAS :	26,20 m ²
13-BAHÇE ALANI :	33.80 m ²

Blok no / Daire no:

E Blok :
1-2 No'lu Daire

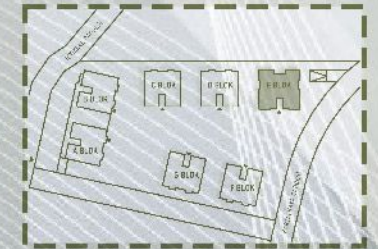

ANAHTAR VAZİYE PLANI

FIDAN PROPERTY



Social Facilities

GYM

Kids Playground

Swimming Pool

Green Areas

Sauna

Parking lots

Security System





Project Location

Istanbul Airport : 26 km

E80 highway : 8 km

Metro Station : 120 m

Taksim : 31 km

Eminönü : 27 km

Nearest Mall : 4.7 km

Nearest Hospital : 3.5 km

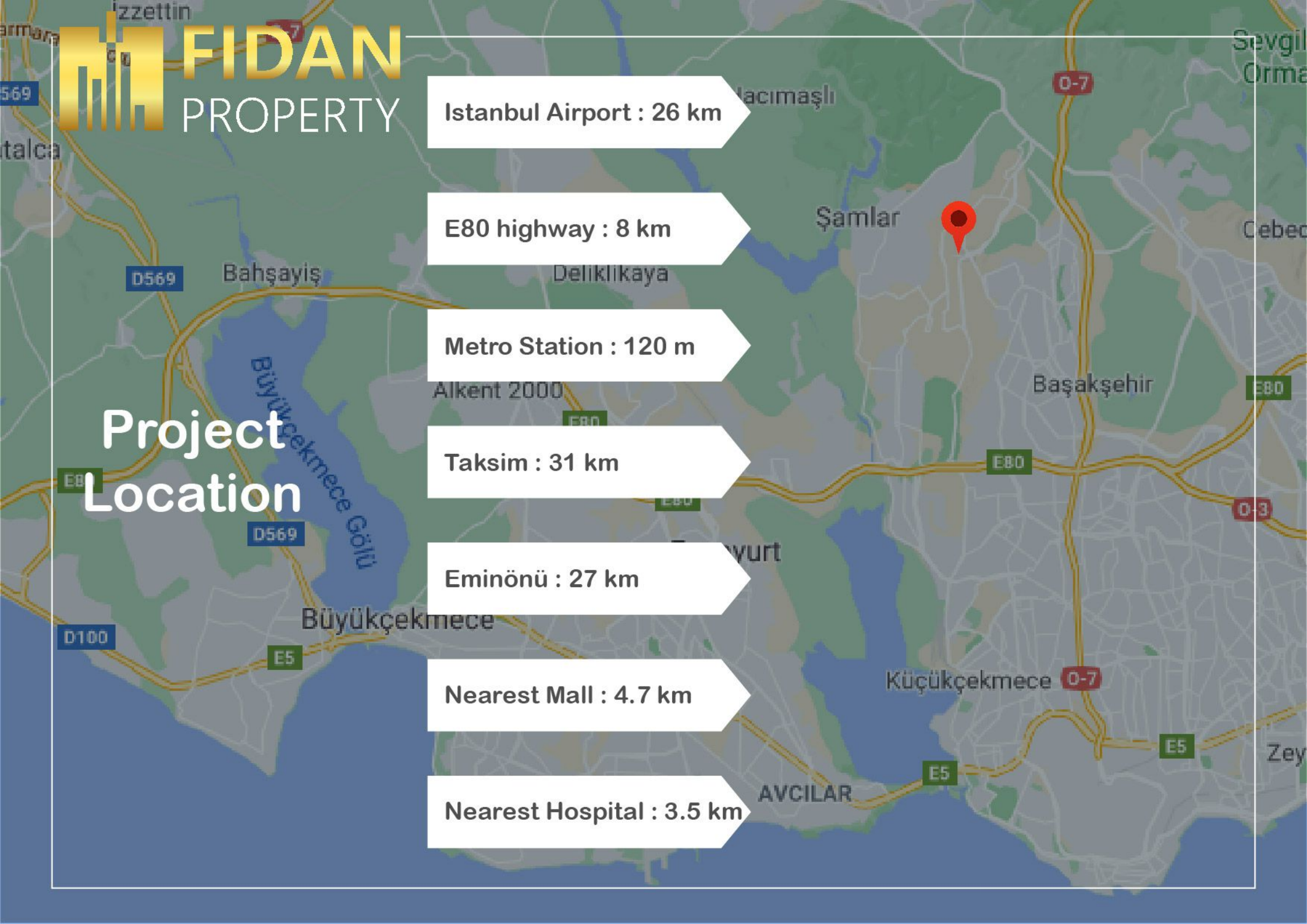

FIDAN
PROPERTY





 +90 552 866 55 57

 info@fidanproperty.com

 www.fidanproperty.com