

A modern building with large glass windows and balconies, set against a twilight sky. The building's facade is dark blue. Through the windows, various interior scenes are visible: a living room with a sofa and chair, a person standing in a room, and two people sitting on a bench. A balcony with a potted tree is also visible. The background shows a cityscape with lights and a body of water under a dark sky.

FIDAN
PROPERTY

FI 659

General Information

Location **Istanbul – Üsküdar**

Apartment type **2+1 - 3+1 - 4+1 - 3+1D - 4+1D**

Price **Starting from 445.000 \$**

Area **102 – 223 m2**

Distance to Taksim **32 Minutes**

Distance to Sabiha Airport **40 Minutes**

Distance to Metro Station **12 Minutes**

Delivery date **2024**





FIDAN
PROPERTY



Price list & Payment method

2+1

3+1

3+1D

4+1

4+1D

102 - 222 m²

132 - 214 m²

153 - 217 m²

208 m²

204 - 223 m²

463.000 - 963.000 \$ 445.000 - 1.019.000 \$ 573.000 - 1.120.000 \$ 704.000 - 1.017.000 \$ 651.000 - 832.000 \$



2+1 C4

C BLOK

1	GİRİŞ HOLÜ	7.30 m ²
2	MUTFAK	7.46 m ²
3	SALON	30.00 m ²
4	BALKON	5.00 m ²
5	BANYO	3.31 m ²
6	EB. YATAK OD.	14.20 m ²
7	EB.BANYO	3.07 m ²
8	YATAK ODASI	9.75 m ²

NET ALAN 80.09 m²
SATIŞA ESAS ALAN 102.01 m²

ANAHTAR PLAN



VAZİYET PLANI



3+1 C2

C BLOK

1	GİRİŞ HOLÜ	3.65 m ²
2	MUTFAK	12.84 m ²
3	SALON	40.06 m ²
4	BAHÇE TERASI	10.39 m ²
5	KORIDOR	11.97 m ²
6	ÇAM. NİŞİ	0.56 m ²
7	BANYO	4.78 m ²
8	EB. YATAK OD.	18.23 m ²
9	EB.BANYO	3.51 m ²
10	YATAK ODASI	9.83 m ²
11	YATAK ODASI	11.24 m ²

NET ALAN 127.06 m²
SATIŞA ESAS ALAN 214.60 m²

TAHSİSLİ SATIŞA ESAS ALAN 21.18 m²

ANAHTAR PLAN



VAZİYET PLANI



3+1 C3

C BLOK

1	GİRİŞ HOLÜ	5.78 m ²
2	MUTFAK	10.93 m ²
3	SALON	31.83 m ²
4	BAHÇE TERASI	9.30 m ²
5	MERDİVEN	4.23 m ²
6	HOL	4.00 m ²
7	ÇAM. NİŞİ	1.05 m ²
8	EB. YATAK ODASI	17.42 m ²
9	EB. BANYO	3.62 m ²
10	YATAK ODASI	10.11 m ²
11	YATAK ODASI	12.40 m ²
12	BANYO	3.49 m ²

NET ALAN 114.16 m²
SATIŞA ESAS ALAN 196.57 m²

TAHSİSLİ SATIŞA ESAS ALAN 35.00 m²

TAHSİSLİ SATIŞA ESAS ALAN
35.00 m²

4
BAHÇE TERASI
9.30 m²

3
SALON
31.83 m²

1
GİRİŞ HOLÜ
5.78 m²

2
MUTFAK
10.93 m²



ANAHTAR PLAN



VAZİYET PLANI



4+1 C8

C BLOK

1	GİRİŞ HOLO	8.78 m ²
2	MUTFAK	13.37 m ²
3	BALKON	15.00 m ²
4	SALON	45.74 m ²
5	BALKON	3.00 m ²
6	BANYO	4.17 m ²
7	ÇAM. NİŞİ	1.04 m ²
8	WC	2.95 m ²
9	EB. YATAK OD.	21.37 m ²
10	EB. BANYO	3.54 m ²
11	YATAK ODASI	15.15 m ²
12	YATAK ODASI	8.73 m ²
13	YATAK ODASI	12.50 m ²
14	BALKON	1.74 m ²
15	KORIDOR	9.24 m ²

NET ALAN 166.32 m²
SATIŞA ESAS ALAN 208.38 m²

ANAHTAR PLAN

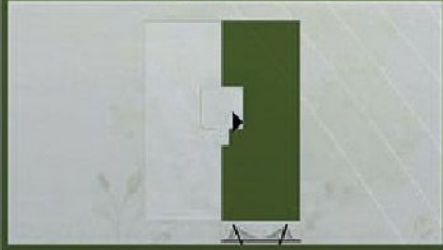

VAZİYET PLANI



4+1 C1

C BLOK

1	GİRİŞ HOLÜ	9.31 m ²
2	MUTFAK	12.35 m ²
3	SALON	35.38 m ²
4	BAHÇE TERASI	10.39 m ²
5	BANYO	3.22 m ²
6	YATAK ODASI	10.50 m ²
7	MERDİVEN	3.49 m ²
8	HOL	5.64 m ²
9	ÇAMAŞIR ODASI	1.10 m ²
10	EB. YATAK OD.	14.61 m ²
11	EB.BANYO	3.08 m ²
12	YATAK ODASI	16.09 m ²
13	BANYO	3.39 m ²
14	YATAK ODASI	9.40 m ²

NET ALAN 137.94 m²
SATIŞA ESAS ALAN 207.42 m²

ANAHTAR PLAN

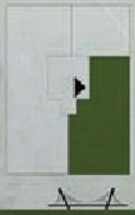

VAZİYET PLANI



FIDAN PROPERTY







Social Facilities

Swimming Pool

Green Areas

Kids Playground

Parking

Security System





FIDAN
PROPERTY



Project Location

Sabiha Airport : 38 km

Bosphorus Bridge : 5 km

Metro Station : 5.5 km

Taksim : 13 km

Eminönü : 18 km

Nearest Mall : 5 km

Nearest Hospital : 4 km

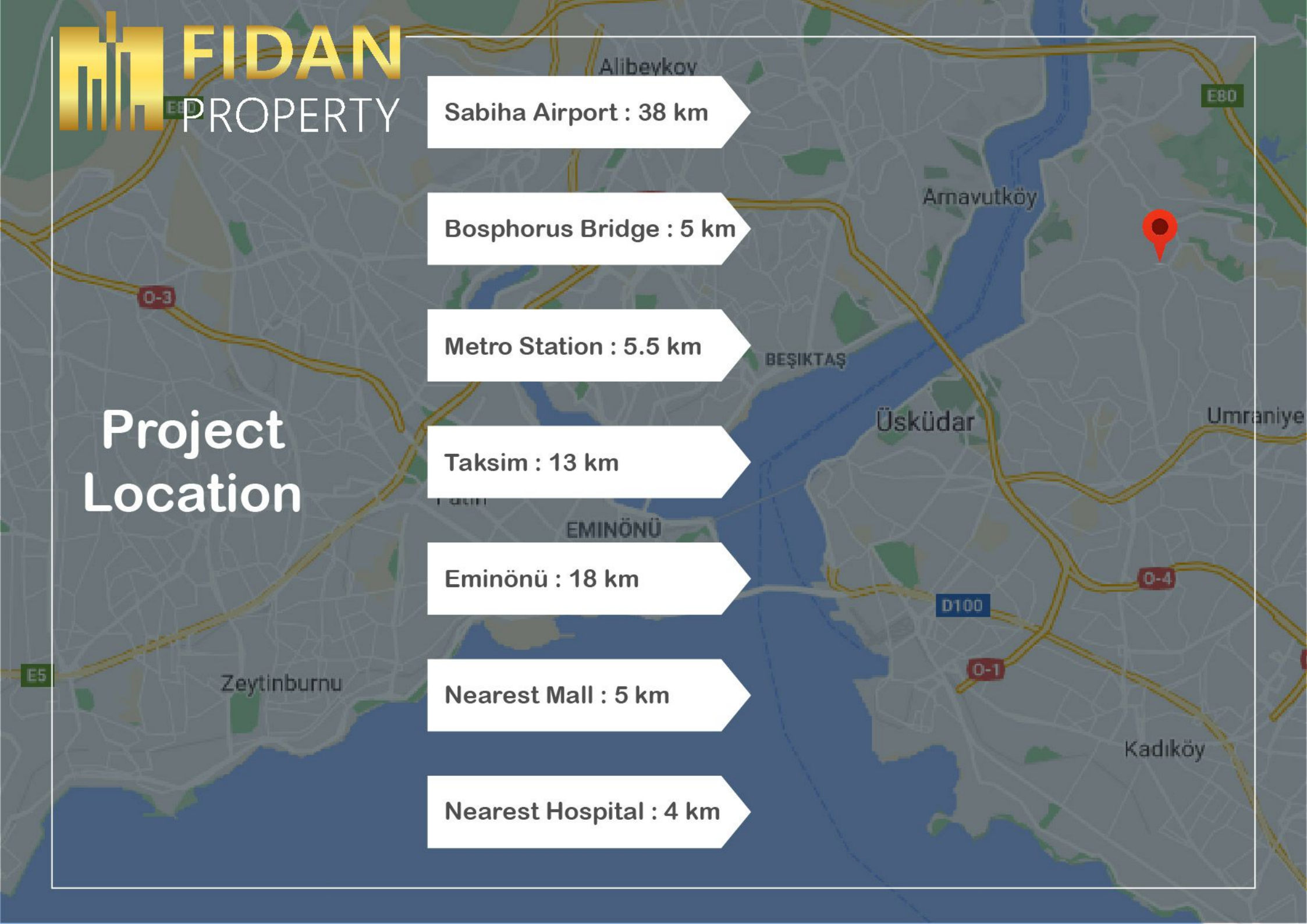

FIDAN PROPERTY



The logo for FIDAN PROPERTY features a stylized golden building icon on the left, composed of several vertical bars of varying heights. To the right of the icon, the word "FIDAN" is written in a large, bold, golden sans-serif font, and the word "PROPERTY" is written below it in a smaller, white sans-serif font.

FIDAN
PROPERTY

 +90 552 866 55 57

 info@fidanproperty.com

 www.fidanproperty.com