



FIDAN
PROPERTY

FI 635

General Information

Location İstanbul – Beylikdüzü

Number of apartments 54

Apartment type 2+1 - 3+1 - 3+2 - 4+1 - 5+2 - 7+2

Price Starting from 250.000 \$

Area 139 – 410 m2

Distance to Taksim 45 Minutes

Distance to Istanbul Airport 50 Minutes

Distance to Metrobus Station 6 Minutes

Delivery date 12 / 2023



FIDAN PROPERTY



Price list & Payment method

2+1

3+1

3+1D

4+1

5+2D

7+2D

139 - 144 m²

221 m²

274 - 280 m²

256 m²

353 m²

410 m²

From 250.000 \$

From 468.000 \$

From 570.000 \$

From 534.000 \$

From 775.000 \$

From 880.000 \$

35 % Down Payment 24 Months Installment



FIDAN PROPERTY



2+1 DAİRE TİPLERİ

2+1 B BLOK

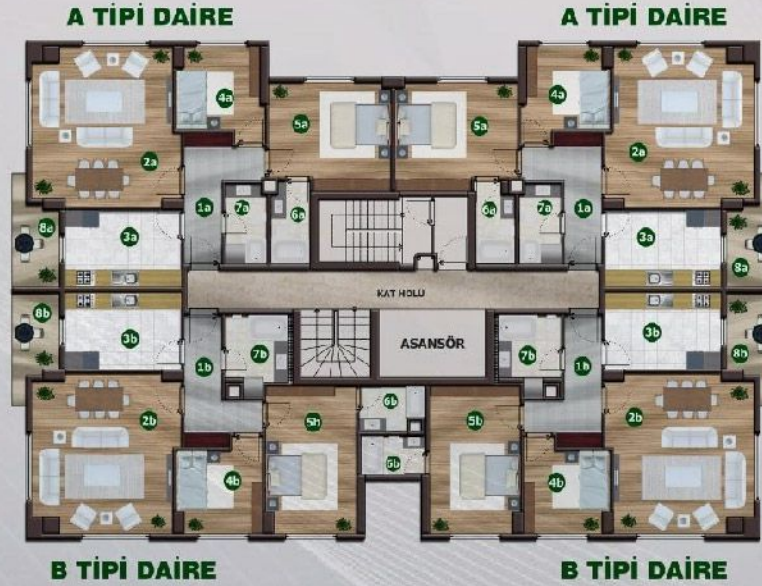

A TİPİ DAİRE

NET ALAN: 87,76 m²

BRÜT ALAN: 173,7 m²

B TİPİ DAİRE

NET ALAN: 90 m²

BRÜT ALAN: 176 m²

A TİPİ DAİRE

1a ANTRE: 8 m²

2a SALON: 29 m²

3a MUTFAK: 11 m²

4a ÇOCUK ODASI: 10 m²

5a YATAK ODASI: 16 m²

6a EBV. BANYO: 4 m²

7a BANYO: 4 m²

8a BALKON: 5 m²

B TİPİ DAİRE

1b ANTRE: 8 m²

2b SALON: 29 m²

3b MUTFAK: 11 m²

4b ÇOCUK ODASI: 10 m²

5b YATAK ODASI: 17 m²

6b EBV. BANYO: 3 m²

7b BANYO: 6 m²

8b BALKON: 6 m²

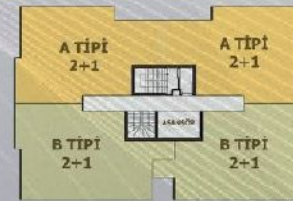

1,2,3,4,5,6,7,8. KAT PLANI

3+1 DAİRE TİPLERİ

3+1 A BLOK



3+1



3+1
NET ALAN: 124 m²
BRÜT ALAN: 220 m²

4+1
NET ALAN: 155 m²
BRÜT ALAN: 257 m²

- | | | |
|----------------------------------|-----------------------------------|------------------------------------|
| 1 ANTRE: 17 m ² | 8 BANYO: 6 m ² | 15 ÇOCUK ODASI: 11 m ² |
| 2 MUTFAK: 13 m ² | 9 BALKON: 5 m ² | 16 YATAK ODASI: 21 m ² |
| 3 SALON: 31 m ² | 10 ANTRE: 18 m ² | 17 EBV. BANYO: 4 m ² |
| 4 ÇOCUK ODASI: 15 m ² | 11 MUTFAK: 16 m ² | 18 GİYİNME ODASI: 3 m ² |
| 5 ÇOCUK ODASI: 13 m ² | 12 SALON: 39 m ² | 19 ÇAMAŞIR ODASI: 2 m ² |
| 6 YATAK ODASI: 21 m ² | 13 ÇOCUK ODASI: 16 m ² | 20 BANYO: 5 m ² |
| 7 EBV. BANYO: 3 m ² | 14 ÇOCUK ODASI: 15 m ² | 21 BALKON: 5 m ² |



1, 2, 3, 4, 5, 6, 7. KAT PLANI

3+2 DUBLEKS DAİRELER

**2+1
B BLOK**



A TIPI DAİRE

NET ALAN: 171,47 m²

BRÜT ALAN: 279 m²

B TIPI DAİRE

NET ALAN: 177,61 m²

BRÜT ALAN: 286 m²

A TIPI DAİRE

DUBLEKS ALT KAT PLANI



B TIPI DAİRE

DUBLEKS ALT KAT PLANI

- 1a ANTRE: 8 m²
- 2a SALON: 29 m²
- 3a MUTFAK: 11 m²
- 4a Ç. ODASI: 10 m²
- 5a Y. ODASI: 14 m²
- 6a EBV. BANYO: 14 m²
- 7a BANYO: 6 m²
- 8a BALKON: 6 m²

A TIPI DAİRE

- 9a SALON: 42 m²
- 10a Y. ODASI: 14 m²
- 11a BANYO: 4 m²
- 12a TERAS: 20 m²

B TIPI DAİRE

- 1b ANTRE: 8 m²
- 2b SALON: 29 m²
- 3b MUTFAK: 11 m²
- 4b Ç. ODASI: 10 m²
- 5b Y. ODASI: 16 m²
- 6b EBV. BANYO: 3 m²
- 7b BANYO: 4 m²
- 8b BALKON: 6 m²

A TIPI DAİRE

DUBLEKS ÜST KAT PLANI



B TIPI DAİRE

DUBLEKS ÜST KAT PLANI

- 9b SALON: 37 m²
- 10b Y. ODASI: 20 m²
- 11b EBV. BANYO: 3 m²
- 12b BANYO: 5 m²
- 13b TERAS: 20 m²

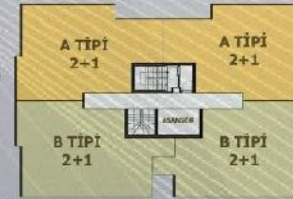

1,2,3,4,5,6,7,8,9. KAT PLANI

4+1 DAİRE TİPLERİ

4+1 A BLOK



3+1
NET ALAN: 124 m²
BRÜT ALAN: 139 m²

4+1
NET ALAN: 155 m²
BRÜT ALAN: 174 m²

- | | | |
|----------------------------------|-----------------------------------|------------------------------------|
| 1 ANTRE: 17 m ² | 8 BANYO: 6 m ² | 15 ÇOCUK ODASI: 11 m ² |
| 2 MUTFAK: 13 m ² | 9 BALKON: 5 m ² | 16 YATAK ODASI: 21 m ² |
| 3 SALON: 31 m ² | 10 ANTRE: 18 m ² | 17 EBV. BANYO: 4 m ² |
| 4 ÇOCUK ODASI: 15 m ² | 11 MUTFAK: 16 m ² | 18 GİYİNME ODASI: 3 m ² |
| 5 ÇOCUK ODASI: 13 m ² | 12 SALON: 39 m ² | 19 ÇAMAŞIR ODASI: 2 m ² |
| 6 YATAK ODASI: 21 m ² | 13 ÇOCUK ODASI: 16 m ² | 20 BANYO: 5 m ² |
| 7 EBV. BANYO: 3 m ² | 14 ÇOCUK ODASI: 15 m ² | 21 BALKON: 5 m ² |



1,2,3,4,5,6,7. KAT PLANI

5+2 DAİRE TİPLERİ

3+1 DUBLEKS A BLOK



DUBLEKS ALT KAT PLANI



DUBLEKS ÜST KAT PLANI

NET ALAN: 246 m²

BRÜT ALAN: 270 m²

- | | |
|----------------------------------|-----------------------------------|
| 1 ANTRE: 13 m ² | 10 ANTRE: 5 m ² |
| 2 MUTFAK: 14 m ² | 11 MUTFAK: 7 m ² |
| 3 SALON: 31 m ² | 12 SALON: 32 m ² |
| 4 ÇOCUK ODASI: 15 m ² | 13 ÇOCUK ODASI: 12 m ² |
| 5 ÇOCUK ODASI: 13 m ² | 14 YATAK ODASI: 23 m ² |
| 6 YATAK ODASI: 21 m ² | 15 BANYO: 5 m ² |
| 7 EBV.BANYO: 3 m ² | 16 HOL: 4 m ² |
| 8 BANYO: 6 m ² | 17 TERAS: 31 m ² |
| 9 BALKON: 5 m ² | |



1,2,3,4,5,6,7. KAT PLANI



8. KAT PLANI

7+2 DAİRE TİPLERİ

4+1 DUBLEKS A BLOK



DUBLEKS ALT KAT PLANI



DUBLEKS ÜST KAT PLANI

NET ALAN: 297 m²

BRÜT ALAN: 434 m²

- | | |
|-----------------------------------|------------------------------------|
| 1 ANTRE: 17 m ² | 11 ÇAMAŞIR ODASI: 2 m ² |
| 2 SALON: 39 m ² | 12 BALKON: 5 m ² |
| 3 MUTFAK: 14 m ² | 13 ANTRE: 5 m ² |
| 4 ÇOCUK ODASI: 16 m ² | 14 SALON: 33 m ² |
| 5 ÇOCUK ODASI: 15 m ² | 15 MUTFAK: 7 m ² |
| 6 ÇOCUK ODASI: 11 m ² | 16 ÇOCUK ODASI: 23 m ² |
| 7 YATAK ODASI: 21 m ² | 17 ÇOCUK ODASI: 10 m ² |
| 8 GİYİNME ODASI: 3 m ² | 18 YATAK ODASI: 17 m ² |
| 9 EBV, BANYO: 4 m ² | 19 BANYO: 5 m ² |
| 10 BANYO: 5 m ² | 20 HOL: 8 m ² |
| | 21 TERAS: 31 m ² |



1,2,3,4,5,6,7. KAT PLANI



8. KAT PLANI

FIDAN PROPERTY







Social Facilities

Turkish Bath

Green Areas

Sauna

Swimming Pool

Kids Playground

Parking

Security System





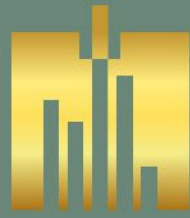

FIDAN
PROPERTY

Project Location

Istanbul Airport : 50 km

Marmara Sea : 3 km

Metrobus Station : 3.5 km

Taksim : 41 km

Eminönü : 37 km

Nearest Mall : 3.8 km

Nearest Hospital : 1 km

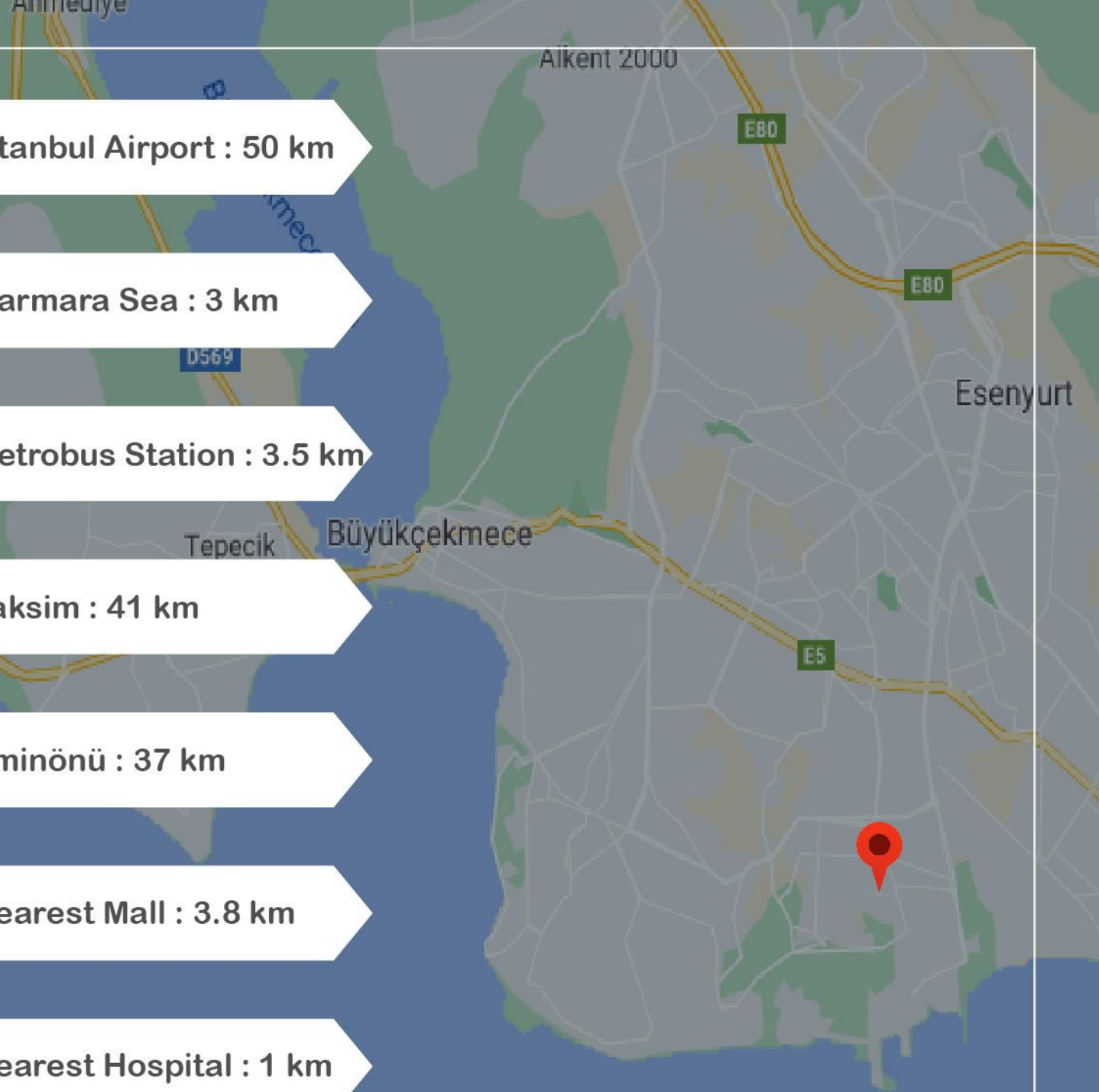





 +90 552 866 55 57

 info@fidanproperty.com

 www.fidanproperty.com